

DEFLEX[®] 446/cxl-170

Pentru pardoseli

Profiluri rosturi de trecere pentru toate tipurile de finisari (carpa manuala, piatra naturala, piatra turnata, etc). Piese de racord intersanjabil, cu suport central si sectiune de ghidare.

A se vedea de asemenea, sfaturile pentru planificare si instalare



Test incendiu in acord cu prevederile clasei E conform DIN EN 13501-1.

Tip	446/cxl-170
Fb [mm] pana la	170
H [mm]	35 / 40* / 50 / 55* / 60 / 80 / 100
B [mm] aprox.	285 / 305*
S [mm] aprox.	200
Miscare w [mm] orizontala	50 (+25/-15)
Culori intercalate	negru, gri
Material	Nitriflex [®] , Aluminium
Lungime standard [m]	4
Capacitate sarcina [kN]	

23

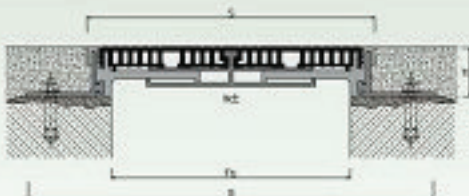

446/cxl-170

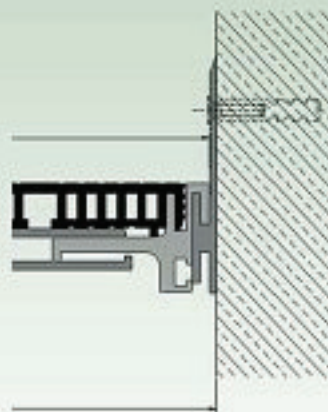

E 446/cxl-170

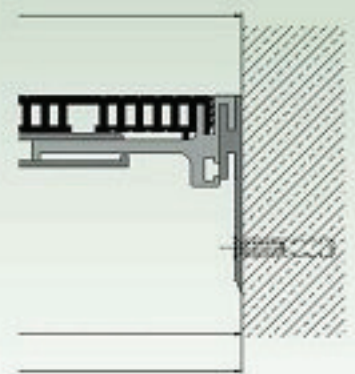

EV 446/cxl-170